

30th June 2020

TO WHOM IT MAY CONCERN

**Re: Letter of Consent to proceed with planning permission application for proposed works at Seafields, Bettystown, County Meath
Applicant: Meath County Council**

Dear Sir/Madam

I hereby consent to **Meath County Council** making a Planning application for works which includes development of Public Library, Life Guard Station, Showers, Changing area at the location **Seafields, Bettystown, Co Meath** on the lands highlighted in grey on the map attached.

Yours faithfully



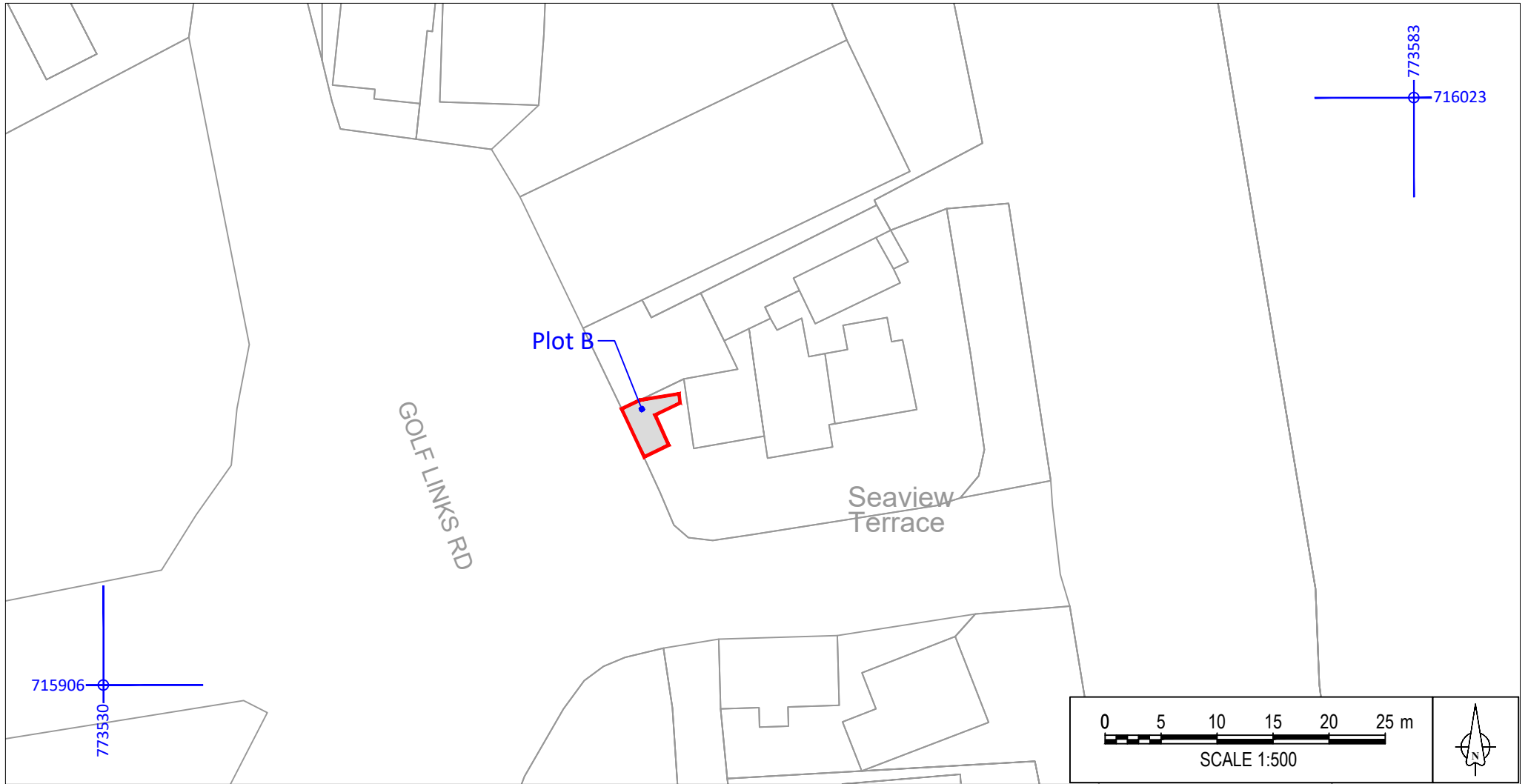

Plot Owner:
Loren Boshell

Address:
1 Seaview Terrace,
Bettystown
Co. Meath

Townland:	Folio Number	Plot Number	Area (HA)
Moyfin (Part of)	MH21683F	B	0.00146

Land shown bounded in red to be transferred to:
Meath County Council

Gross Area	0.00146
------------	---------



MEATH COUNTY COUNCIL,
BUVINDA HOUSE,
DUBLIN ROAD,
NAVAN,
CO. MEATH.
C15 Y291

TEL. 046 9097000
FAX. 046 9097001
WEB. www.meathcoco.ie

PROJECT:
CS - Land Purchase

TRACED
SURVEYED
DRAWN J. Smith
DESIGNED
CHECKED D. McGowan

COPYRIGHT
ORDNANCE SURVEY OFFICE
&
MEATH COUNTY COUNCIL

REV.	DESCRIPTION	BY	CHK	DATE

NOTES:

HORIZONTAL	As Shown @ A4
VERTICAL	
DATE	19th March 2020
DATUM	

DRAWING TITLE:
Purchase of Lands

DRAWING NO: CS - Land Purchase

This is a Computer Generated Map -
OS Licence No. 2020/31/CCMA/Meath County Council
This map is drawn to the Largest Scale
published by the Ordnance Survey