

THE INFORMATION ON THIS DRAWING IS TO THE ORDNANCE SURVEY IRELAND ITM COORDINATE SYSTEM

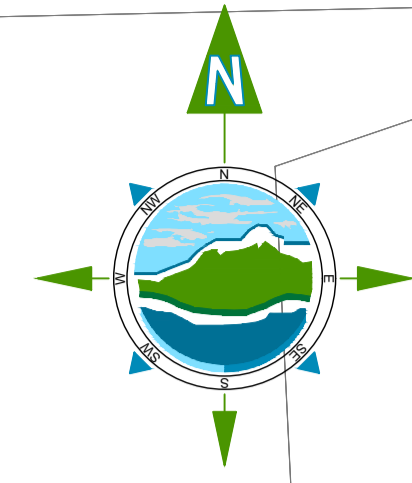

LEGEND

- OUTLINE OF PROPOSED SITE WORKS
- - - EXISTING WATERMAIN FROM IRISH WATER RECORDS
- - - PROPOSED 100mm WATERMAIN
- EXISTING 100mm WATERMAIN
- - - INDICATIVE LOCATION OF EXISTING 100mm WATERMAIN TO BE DECOMMISSIONED
- EXISTING 100mm WATERMAIN TO BE DECOMMISSIONED
- H FIRE HYDRANT
- SV SLUICE VALVE
- SCV SCOUR VALVE
- AV AIR VALVE
- PROPOSED STOPCOCK AND WATER METER BOUNDARY BOX

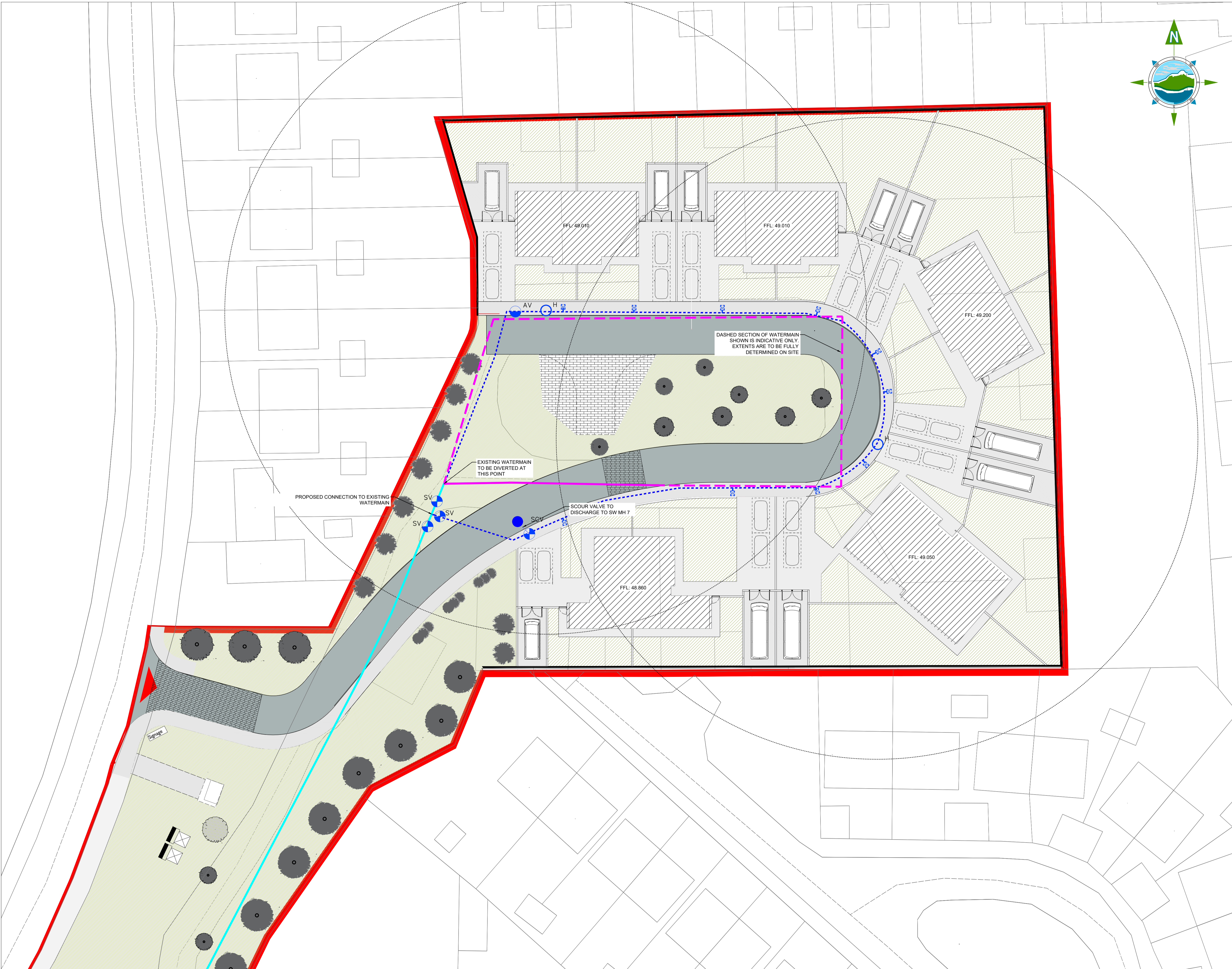

Rev	Date	Description	By	Chkd.
P01	MAR '21	Planning Issue	AO'S	KH

Client:

comhairle chontae na mí
meath county council

Project:

**DEVELOPMENT AT
ST. FRANCIS PARK,
CO. MEATH**

Title:

**PROPOSED
WATERMAIN LAYOUT**

Scale @ A1: **1:250**

Prepared by: AO'S Checked: KH Date: March 2021

Project Director: **Brian Carroll**

Status: **PLANNING**

TOBIN
Patrick J. Tobin & Co. Ltd.

TOBIN Consulting Engineers,
Block 10-4, Blanchardstown Corporate Park,
Dublin 15, Ireland.
tel: +353-(0)1-8030406
fax: +353-(0)1-8030409
e-mail: dublin@tobin.ie
www.tobin.ie

TOBIN Consulting Engineers will not be liable for any use of this document for any purpose other than that for which it was originally prepared and approved. Except where specifically stated, liability shall remain with the Client. Engineers, architects, planners, etc. shall not be held responsible for any errors or omissions in any form and this document shall not be relied upon by any third party for any purpose.

Drawing No.: **7997-2020** P01 Revision: