

The user or recipient of this survey data understands and acknowledges this data may be inaccurate or contain errors or omissions and the user or recipient assumes full responsibility for any risks or damages resulting from, arising from, or in connection with any use of or reliance upon data displayed herein. -- Although significant care has been exercised to produce surveys that satisfy survey accuracy standards, these surveys are only as accurate as the source data from which they were compiled. Although all reasonable steps have been taken to locate all features visible at the time of the survey, there is no guarantee that all will be shown on the drawing, as some above ground features may have obstructed the survey. Wherever possible, areas unable to be surveyed will be labelled as "UTS".

The Company shall not be liable for any inaccuracy of the data provided beyond the specified scale or accuracy, or for any matters resulting from their use for purposes other than that stated in the Contract. No liability shall attach to the Surveyor in respect of any consequential loss or damages suffered by the Client.

The Client must promptly notify the Company of any errors in mapping of which it becomes aware. If information is brought to the Company's attention or if the Client identifies any such imprecision or error, the Company shall not be liable for any such errors. We use industry approved underground utility detection equipment and methodology to carry out our surveys. The equipment and methodology used include Ground Penetrating Radar, Cable Avoidance Tool, Manhole Surveys, Site Visual Inspection and Global Positioning System. The performance of these equipment depend on some factors (please refer to manufacturer manual). GeoSurvey cannot guarantee that all utilities have been detected and will not accept liabilities for any decisions made based on this drawing.

Notes:

1. The underground utility surveys was carried out in Rathmylon, Co Meath between 19/03/2019 and 27/03/2019
2. The survey involves GPR and CAT scanning, Manhole logging, drainage manhole rodding and GPS storage of the detected utilities
3. GPR pulses were able to penetrate up to 1.3 m bgl in some parts of this site
4. Additional deeper or smaller sized objects may exist underneath the site (Exercise Caution When Drilling or Excavating)
5. Rebar (mesh) were detected on site and this may affect the resolution of the GPR and CAT
6. All pipe/duct sizes are in millimeters while utility depths are in meters
7. All depths are estimate, not exact
8. Tall grass on this site may affect the resolution of the GPR
9. Every effort have been made to assigned the detected objects to utility types, however, this should be verified prior to use for design purpose
10. ESB, GNI, eir, Virgin Media, e-net records, Water and Drainage records were obtained from the service providers

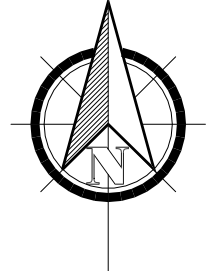

LEGEND SERVICES	
[Red line]	Electrical
[Blue line]	Electrical Records
[Black line]	Telecom
[Dashed black line]	Probable Telecom
[Blue wavy line]	Water
[Blue dashed wavy line]	Probable Water
[Black wavy line]	Water Records
[Green wavy line]	Gas Mains
[Yellow wavy line]	Gas Records
[Orange wavy line]	Foul Sewer
[Red wavy line]	Assumed Foul Sewer
[Green wavy line]	Storm Water
[Blue wavy line]	Assumed Storm Water
[Black dashed line]	Flow Direction
[Black dashed line]	Empty Duct

LEGEND TOPOGRAPHICAL			
[Symbol]	DESCRIPTION	SYMBOL	DESCRIPTION
STN	▲ SURVEY STATION	BLD	BUILDING
OSP	○ SURVEY POINT	SMK	STONE WALL
SPK	○ SPOT HEIGHT	BNL	RAIL
APX	± APX	RE	ROAD EDGE
AT	± AT	HE	HEGGE
GAT	± GATE	KB	KORB (DRAKE)
EP	+ EP	KB	KORB (TOP)
GL	± GL	FP	FLOOR PLAN
SL	+ SL	IB	TOP OF BANK
SLY	+ SLY	BB	BOTTOM OF BANK
WH	○ WH	INV	INVERT
WHC	○ WHC	SL	SHRUB LINE
WHM	○ WHM	SP	STEPS
WHB	○ WHB	SHD	SHED
WHF	○ WHF	PFM	POST AND WIRE FENCE
WHG	○ WHG	DEL	OVERHEAD ESB
WHI	○ WHI	DEL	OVERHEAD TELECOM
WHJ	○ WHJ	DOG	OVERSLOW
WHK	○ WHK	UST	UNDERGROUND STORM
WHL	○ WHL	UTL	UNDERGROUND TOOL
WHM	○ WHM	UTE	UNDERGROUND TELECOM
WHN	○ WHN	VEL	UNDERGROUND ESB
WHO	○ WHO	CR	CONTOUR LINE

Rev.	Date	By	Description

GEO SURVEY LAND SURVEYORS
 when it has to be precise and on time

**Suite 3503 Balmoral Ind. Estate
 Fitwilliam Bussines Center
 Kells Road , Navan , co Meath**

Tel: 046 907 16 08
mob: 0857693168
Email: info@geosurvey.ie
Website: www.geosurvey.ie

TITLE TOPOGRAPHICAL AND SERVICES SURVEY			
PROJECT	Rathmylon Co.Meath	GRID	ITM
CLIENT	Meath County Council	DATUM	MALIN HEAD
SCALE	1:500	SCALE	1:500
DRAWN	DATE	SHEET	DRG.NO.
M.S./P.S.	A1	27.03.2019	190221

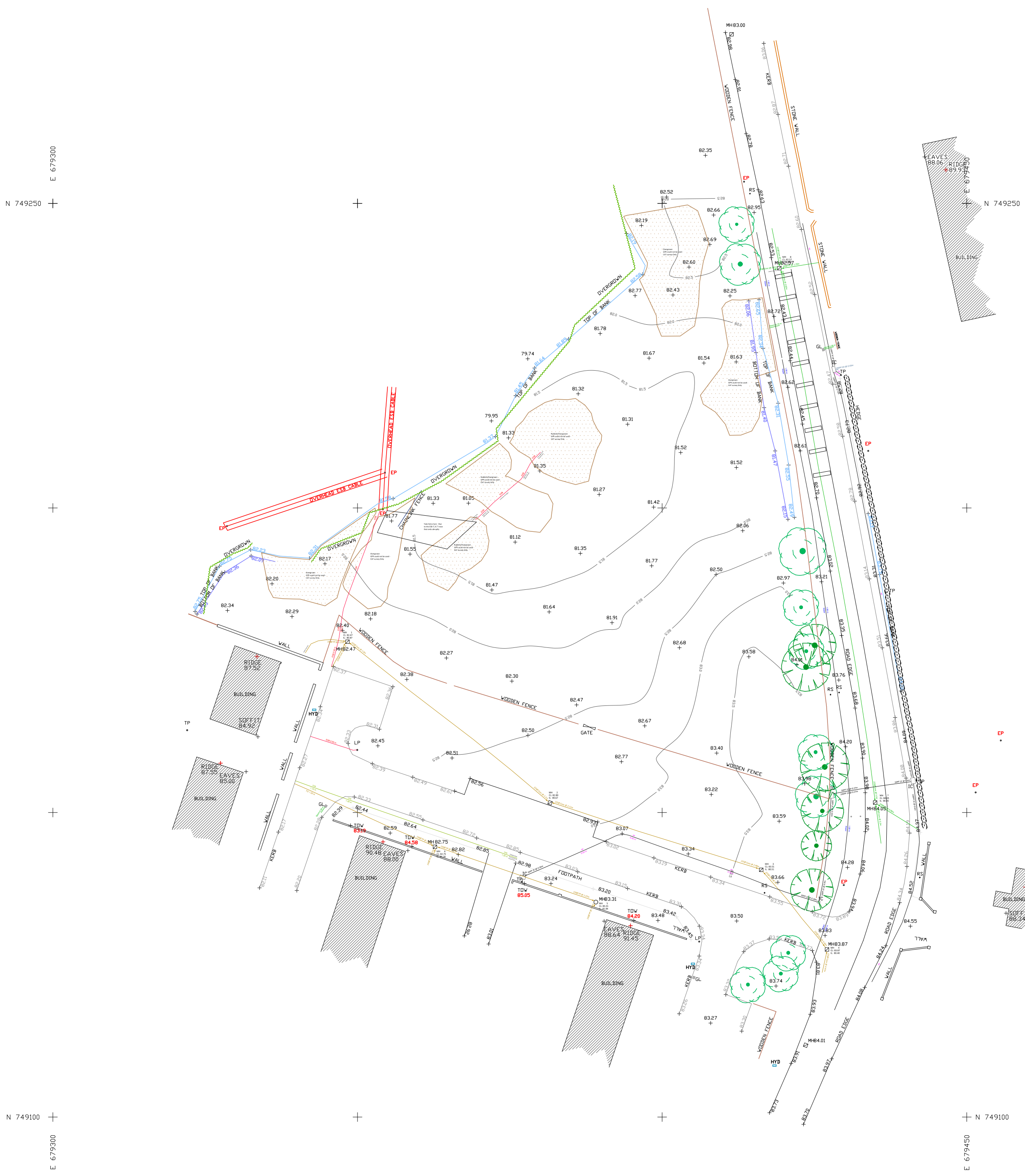
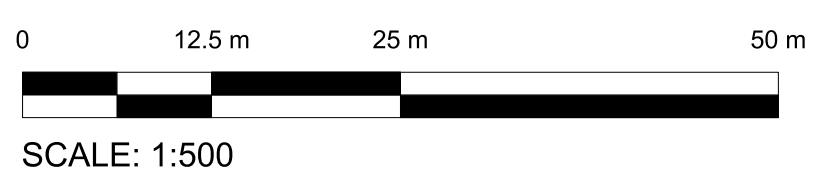

N 749250
E 679300
N 749100
E 679450

THIS DRAWING IS CONFIDENTIAL AND MAY NOT BE REPRODUCED WITHOUT WRITTEN PERMISSION OF GEO SURVEY LAND SURVEYORS