

100
10
0
A1

DO NOT SCALE

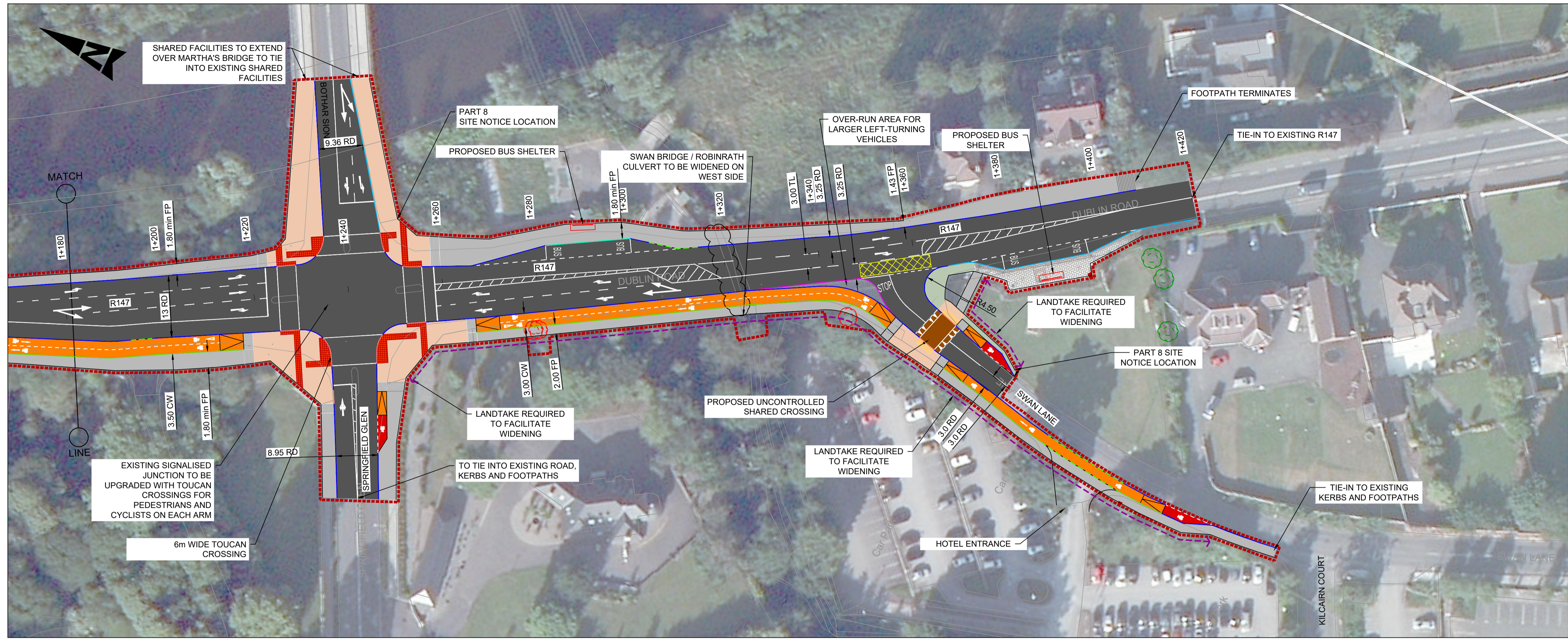

- GENERAL NOTES**
1. ALL DIMENSIONS ARE IN MILLIMETRES UNLESS NOTED OTHERWISE
 2. ONLY WRITTEN DIMENSIONS SHALL BE USED. NO DIMENSIONS SHALL BE SCALED FROM THE DRAWINGS
 3. ALL LEVELS ARE IN METRES AND ARE TO MALIN HEAD DATUM
 4. ALL COORDINATES ARE IN METRES AND ARE TO IRISH TRANSVERSE MERCATOR
 5. DRAWINGS ARE TO BE READ IN CONJUNCTION WITH THE SPECIFICATION

- LEGEND:**
- SITE BOUNDARY
 - BEVELLED ENTRANCE KERB
 - 100mm CONCRETE KERB
 - 60mm UPSTAND KERB
 - 25mm UPSTAND KERB
 - KASSEL KERB
 - FLUSH KERB
 - CARRIAGEWAY
 - PROPOSED FOOTPATH
 - PROPOSED SHARED SPACE
 - PROPOSED RAISED CYCLE TRACK
 - PROPOSED ON ROAD CYCLE LANE
 - PROPOSED TACTILE PAVING (CONTROLLED)
 - TACTILE PAVING (UNCONTROLLED CROSSING)
 - PROPOSED TACTILE PAVING (CORDUROY)
 - PROPOSED GRASS VERGE
 - PROPOSED OVER RUN AREA
 - EXISTING GRASS VERGE TO BE RETAINED
 - EXISTING FOOTPATH TO BE RETAINED
 - EXISTING KERB TO BE RETAINED
 - PROPOSED CYCLE RAMP
 - PROPOSED BUS SHELTER
 - DELINEATOR POSTS
 - CW CYCLEWAY
 - FP FOOTPATH
 - RD ROAD
 - SA SHARED AREA
 - TL TURNING LANE
 - LANDTAKE REQUIRED TO FACILITATE WIDENING
- EXISTING TREES:**
- TO BE RETAINED (WITHOUT MITIGATION MEASURES)
 - TO BE RETAINED (WITH MITIGATION MEASURES)
 - TO BE REMOVED (AS A RESULT OF THE PROPOSED SCHEME)
 - PROPOSED TREES
 - PROPOSED WILDFLOWER MEADOW AREA
 - FORMAL HEDGE

- NOTES:**
1. PROPOSED CYCLE TRACKS, CYCLE LANES TO BE 2.0m WIDE UNLESS NOTED OTHERWISE.
 2. PROPOSED FOOTWAYS SHALL BE 1.8m MIN WIDE UNLESS NOTED OTHERWISE.

© ORDNANCE SURVEY IRELAND. ALL RIGHTS RESERVED.
LICENCE NUMBER 2022/151/NMA/MEATHCOUNTYCOUNCIL

File: 521234_HTR_DR_0123.dwg
Date: Aug 31, 2022 - 5:18pm
Plotted by: DBrien



Rev	Description	By	Date	Chk'd	Auth
A	FINAL FOR PLANNING	CL	26/08/22	JMC	ST
-	PART 8 PLANNING	CL	08/08/22	JMC	ST

ATKINS
Member of the SNC-Lavalin Group

Atkins House, 150-155 Airside
Business Park, Swords, Co. Dublin
Tel (+353) 01 810 8000
Fax (+353) 01 810 8001

Unit 2B, 2200 Cork Airport
Business Park, Cork
Tel (+353) 021 429 0300
Fax (+353) 021 429 0360

1st Floor Technology House
Parkmore Technology Park, Galway
Tel (+353) 091 786 050
Fax (+353) 091 779 830

Client: MEATH COUNTY COUNCIL

Project: NAVAN CYCLE SCHEME
R147 MARTHA'S BRIDGE TO
CIRCULAR ROAD

Purpose: PART 8 PLANNING			
Title: GENERAL ARRANGEMENT SHEET 3 OF 3			
Original Scale: 1:500 @ A1 1:1000 @ A3	Design/Drawn: CL	Checked: JMC	Authorised: ST
Date: 08/08/22	Date: 08/08/22	Date: 08/08/22	Date: 08/08/22
Status: P	Drawing Number: 5212334 / HTR / DR / 0123	Rev: A	