



GREENOGE

LEGEND:

- PROPOSED PART 8 EXTENTS
- LOCATION OF SITE NOTICE

BROAD MEADOW RIVER

R125

LOCATION OF SITE NOTICE NO. 2

LOCATION OF SITE NOTICE NO. 1

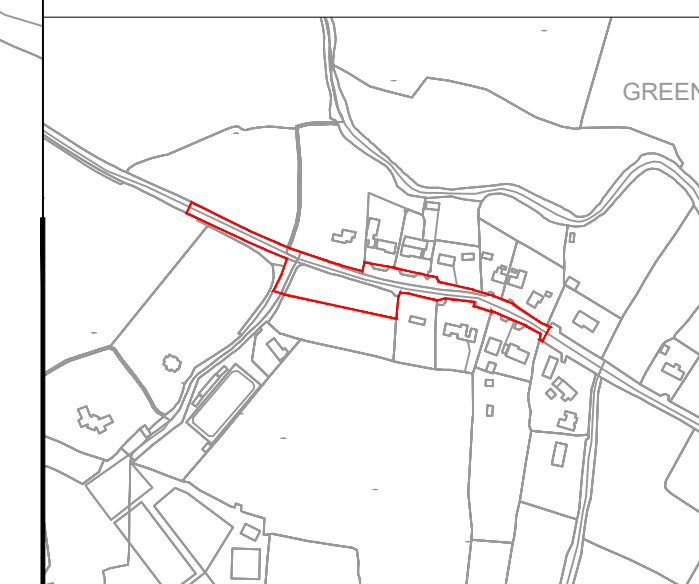

| Rev. | Date | Revision/Details | Drawn | Checked | Approved |
|------|----------|------------------|-------|---------|----------|
| A | 09/12/23 | Issued | PK | AM | AM |

© This drawing is the property of SYSTRA Limited and the information can only be reproduced with their prior permission.



2nd Floor, Riverview House
21-23 City Quay, Dublin 2
D02 FP21 Tel: +353 1 566 2028

Client
MEATH COUNTY COUNCIL

Project
GREENOGE RURAL BUS STOPS SCHEME

Title
**PART VIII DRAWINGS
SITE LOCATION MAP**

| | | | | | |
|--------------------|--------|----------------|-------------------|----------|--------|
| Drawn | PK | Checked | AM | Approved | AM |
| Original dtp. size | A1 | Date | December 2023 | Scale | 1:1000 |
| Drawing Status | Issued | Drawing Number | IE01T23A58-P8-001 | Rev. | A |



LEGEND:

- ▬ PROPOSED PART 8 EXTENTS
- PROPOSED KERB
- PROPOSED KASSEL KERB
- PROPOSED TIMBER POST AND RAIL FENCING
- PROPOSED CONCRETE FOOTPATHS
- PROPOSED TACTILE PAVING
- PROPOSED GRASS VERGES
- PROPOSED NATIVE TREES AND HEDGE PLANTING
- PROPOSED TRAFFIC SIGNS
- ⦿ PROPOSED PUBLIC LIGHTING
- EXTENTS OF LAND ACQUISITION

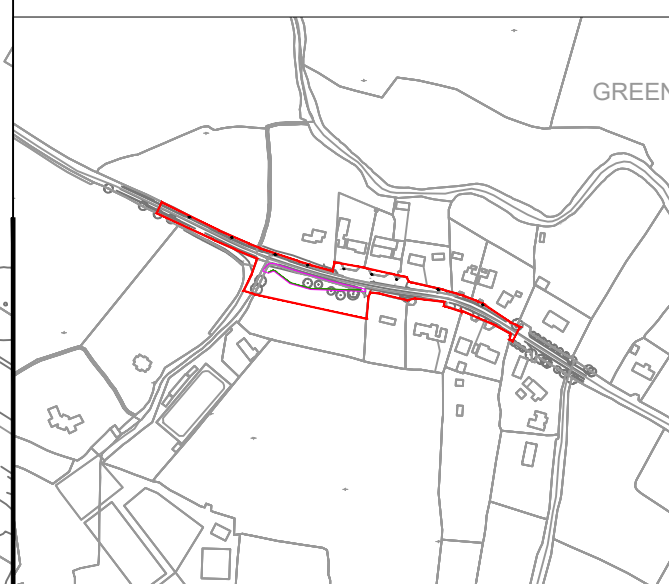

| Rev. | Date | Revision Details | Drawn | Checked | Approved |
|------|----------|------------------|-------|---------|----------|
| A | 09/12/23 | Issued | PK | AM | AM |

© This drawing is the property of SYSTRA Limited and the information can only be reproduced with their prior permission.

SYSTRA
www.systra.ie

2nd Floor, Riverview House
21-23 City Quay, Dublin 2
D02 FP21 Tel: +353 1 566 2028

MEATH COUNTY COUNCIL

Project
GREENOGUE RURAL BUS STOPS SCHEME

Title
PART VIII DRAWINGS
SITE LAYOUT PLAN

| | | | |
|--------------------|-------------------|----------|--|
| Drawn | Checked | Approved | |
| PK | AM | AM | |
| Original dtp. size | Date | Scale | |
| A1 | December 2023 | 1:500 | |
| Drawing Status | Drawing Number | Rev. | |
| Issued | IE01T23A58-P8-002 | A | |

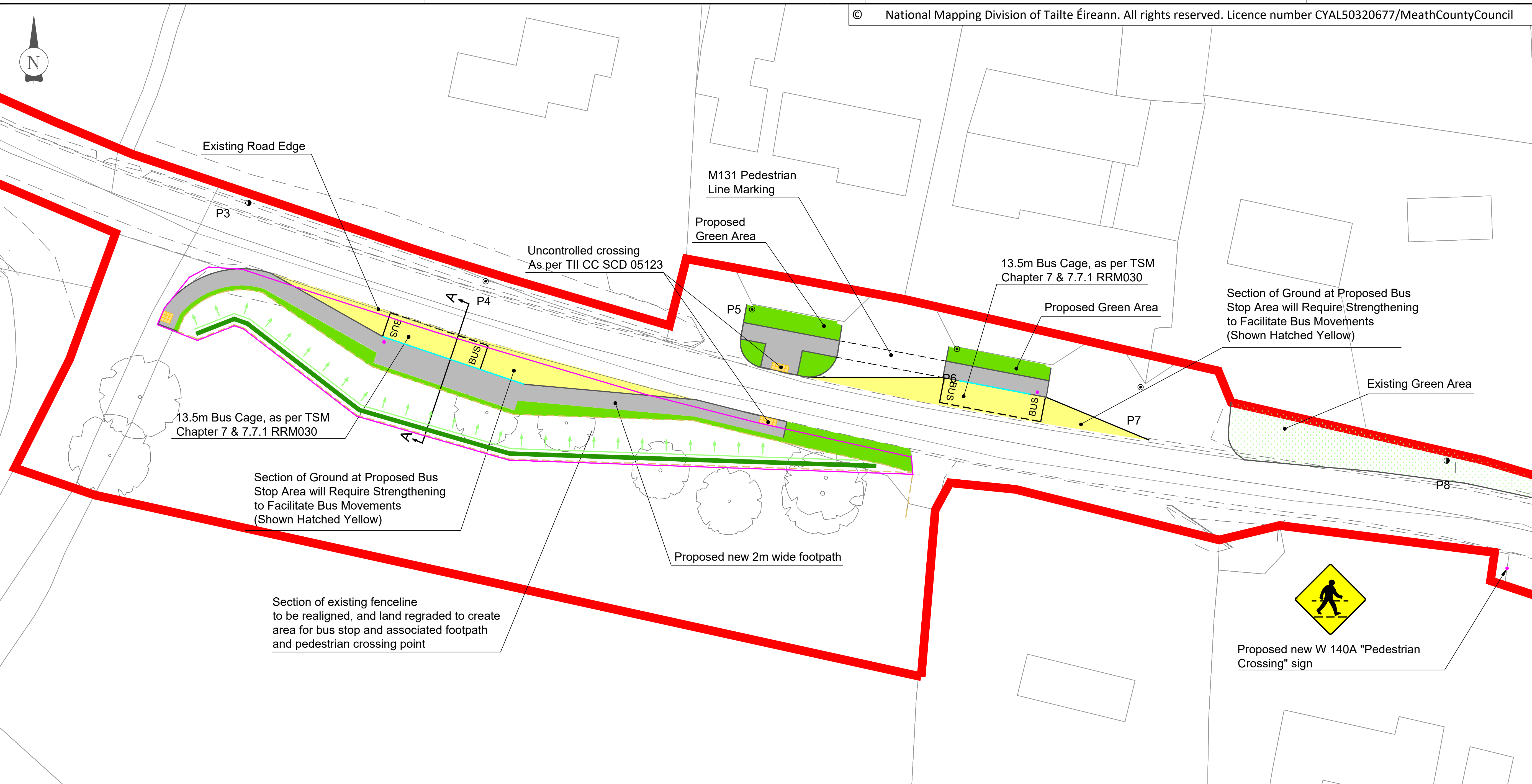
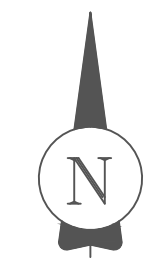

- LEGEND:**
- PROPOSED PART 8 EXTENTS
 - PROPOSED KERB
 - PROPOSED KASSEL KERB
 - PROPOSED TIMBER POST AND RAIL FENCING
 - PROPOSED CONCRETE FOOTPATHS
 - PROPOSED TACTILE PAVING
 - PROPOSED GRASS VERGES
 - PROPOSED NATIVE TREES AND HEDGE PLANTING
 - PROPOSED TRAFFIC SIGNS
 - ⊙ PROPOSED PUBLIC LIGHTING
 - EXTENTS OF LAND ACQUISITION

Existing Field | 6m Regraded Slope and Verge | Proposed 3.3m Footpath | Proposed 3m wide Bus Bay | R125 Existing Carriageway Various Width | Existing Verge

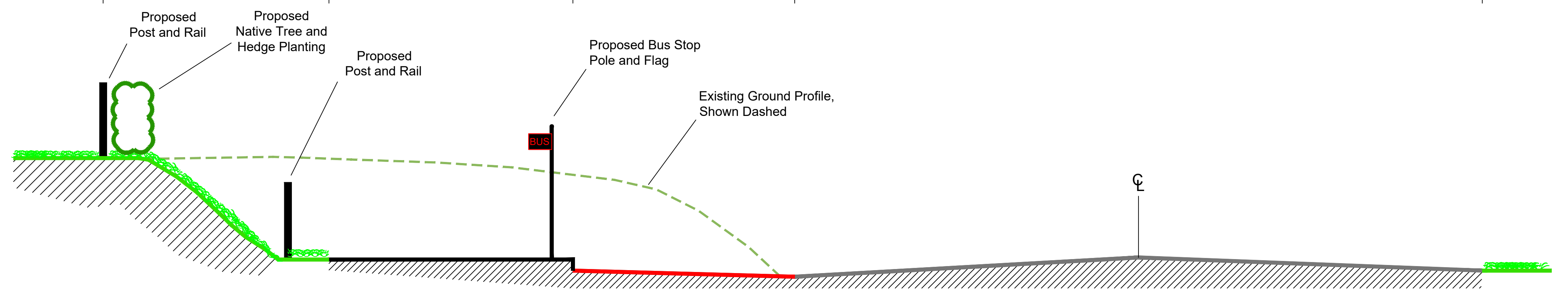

Section A - A



| Rev | Date | Revision Details | Drawn | Checked | Approved |
|-----|----------|------------------|-------|---------|----------|
| A | 09/12/23 | Issued | PK | AM | AM |

© This drawing is the property of SYSTRA Limited and the information can only be reproduced with their prior permission.

SYSTRA
www.systra.ie

2nd Floor, Riverview House
21-23 City Quay, Dublin 2
D02 FP21 Tel: +353 1 566 2028

MEATH COUNTY COUNCIL

GREENOGUE RURAL BUS STOPS SCHEME

PART VIII DRAWINGS
SITE LAYOUT PLAN

| Drawn | Checked | Approved |
|-------------------|-------------------|----------|
| PK | AM | AM |
| Original dtp size | Date | Scale |
| A1 | December 2023 | 1:250 |
| Drawing Status | Drawing Number | Rev |
| Issued | IE01T23A58-P8-003 | A |