

For tree details and further information, please refer to Arborist's Report (dated 12th Sept 2018) **TREE SCHEDULE**

Tree No.	Tree species	Action	Note
560	Acer pseudoplatanus	Removed	Removed due to physical constraint (wall construction)
561	Fraxinus excelsior	Removed	Removed due to physical constraint (wall construction)
562	Acer pseudoplatanus	Removed	Removed due to physical constraint (wall construction)
563	Salix caprea	Removed	Removed due to physical constraint (wall construction)
564	Salix caprea	Removed	Removed due to physical constraint (wall construction)
565	Acer pseudoplatanus	Removed	Removed due to physical constraint (wall construction)
566	Salix caprea	Removed	Removed due to physical constraint (wall construction)
567	Acer pseudoplatanus	Removed	Removed due to physical constraint (wall construction)
568	Acer pseudoplatanus	Removed	Removed due to physical constraint (wall construction)
569	Sambuca nigra	Removed	Removed due to physical constraint (wall construction)
570	Acer pseudoplatanus	Retained	Retained due to distant proximity from development and quality of tree
571	Acer pseudoplatanus	Removed	Removed due to physical constraint (wall construction)
572	Acer pseudoplatanus	Retained	Removed due to physical constraint (wall construction)
573	Acer pseudoplatanus	Removed	Removed due to physical constraint (wall construction)
574	Acer pseudoplatanus	Removed	Removed due to physical constraint (wall construction)
575	Sambuca nigra	Removed	Removed due to physical constraint (wall construction)
576	Acer pseudoplatanus	Removed	Removed due to physical constraint (wall construction)
577	Cotoneaster horizontalis	Removed	Removed due to physical constraint (wall construction)
578	Tilia cordata	Removed	Removed due to low quality (Cat. U) of tree
579	Acer pseudoplatanus	Removed	Removed due to low quality (Cat. C) of tree
580	Cotoneaster horizontalis	Removed	Removed due to physical constraint (wall construction)
581	Cotoneaster horizontalis	Removed	Removed due to low quality (Cat. C) of tree
582	Acer pseudoplatanus	Removed	Removed due to low quality (Cat. U) of tree
583	Acer pseudoplatanus	Removed	Removed due to physical constraint (wall construction)
584	Fraxinus excelsior	Retained	Retained due to distant proximity from development and quality of tree
585	Fagus sylvatica	Retained	Retained due to distant proximity from development and quality of tree
586	Tilia cordata	Retained	Retained due to distant proximity from development and quality of tree
587	Tilia cordata	Retained	Retained due to distant proximity from development and quality of tree
Total quantity retained		6	
Total quantity removed		22	

Quantity	Tree species	Action	Note
21 no.	Tilia cordata	Proposed	Street trees
3 no.	Acer platanoides	Proposed	
3 no.	Quercus robur	Proposed	Proposed as part of the woodland setting along the north side of the boundary wall.
3 no.	Aesculus hippocastanum	Proposed	
Total quantity proposed		30	

KEY PLAN

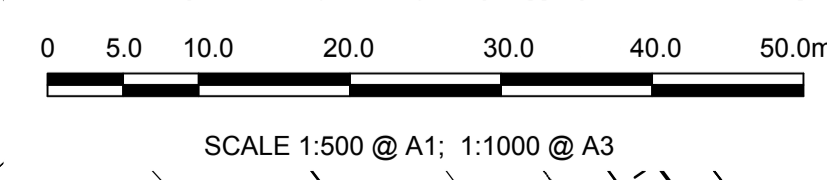
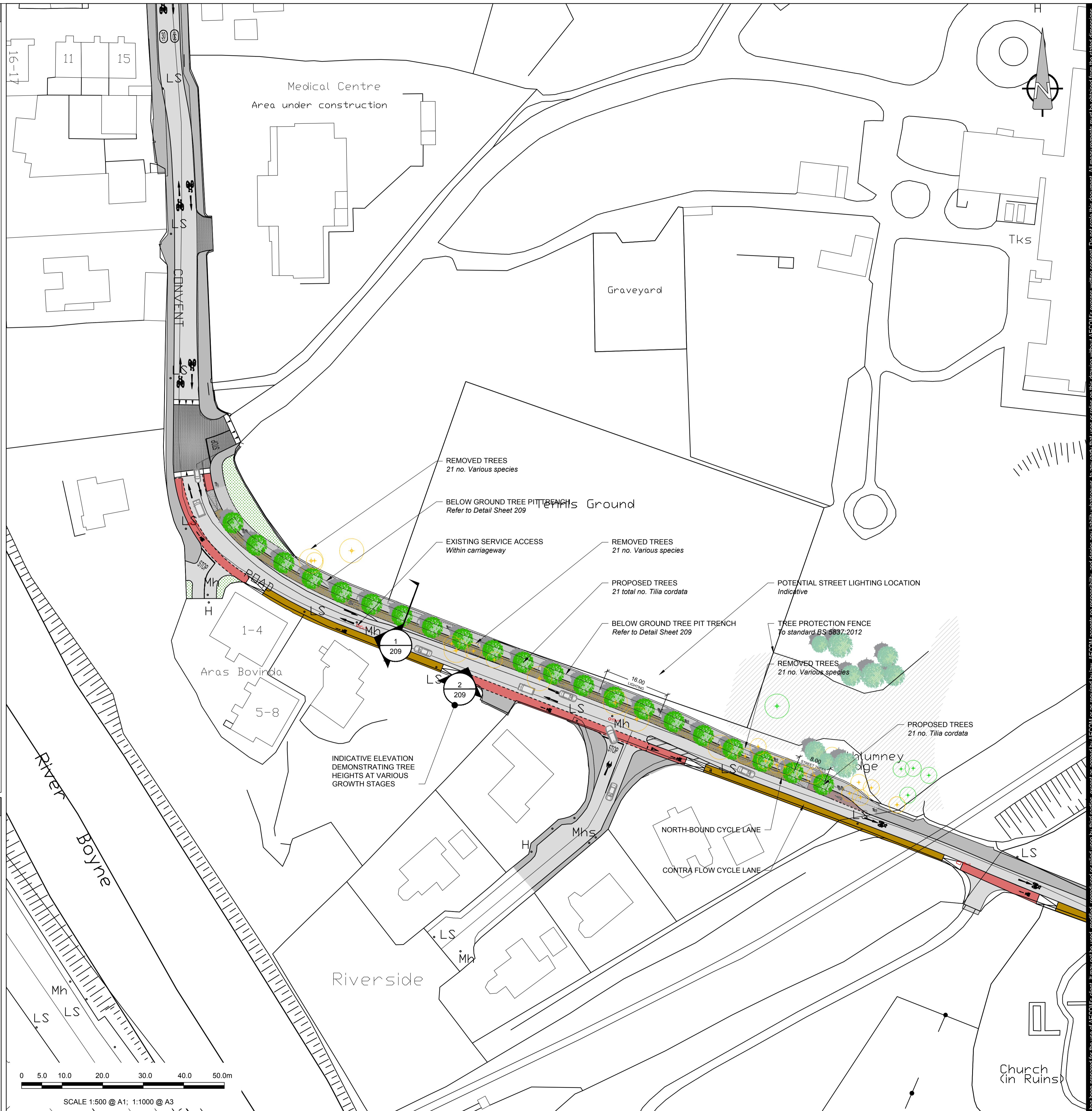
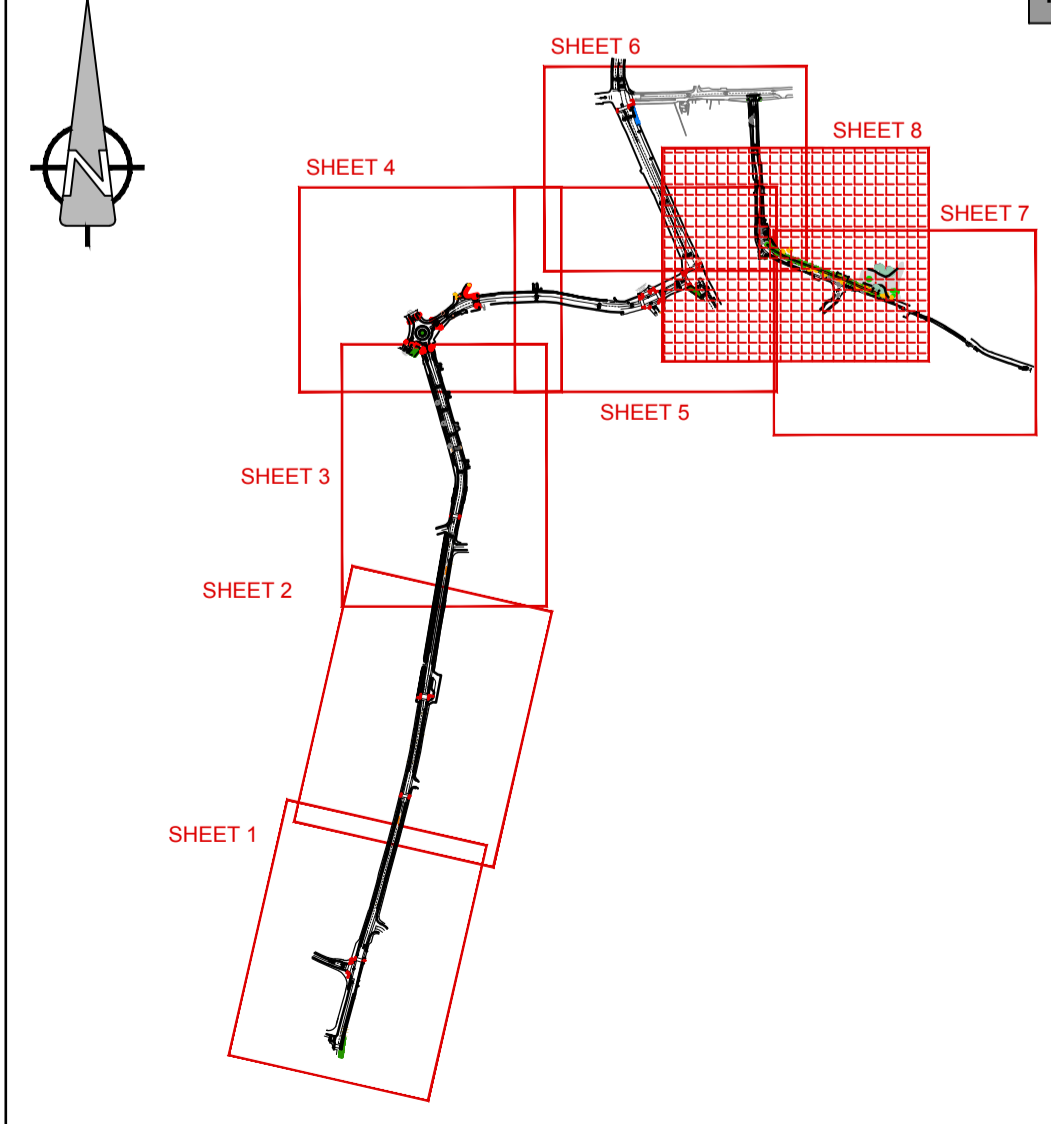

PROJECT
NAVAN CYCLE NETWORK

CLIENT
comhairle chontae na mi
meath county council
Tel: 046-9097000 Fax: 046-9097001
www.meathcoco.ie

CONSULTANT
AECOM
Adelphi Plaza
George's Street Upper
Dun Laoghaire Co. Dublin
+353 (0) 1 238 3100 tel
+353 (0) 1 238 3199 fax
www.aecom.com

- NOTES:**
- THIS DRAWING IS TO BE READ IN CONJUNCTION WITH ALL OTHER RELEVANT ARCHITECTURAL AND ENGINEERING DRAWINGS. ANY DISCREPANCIES, ERRORS OR OMISSIONS TO BE BROUGHT TO THE ATTENTION OF THE DESIGNER.
 - ALL DIMENSIONS TO BE CHECKED BY THE CONTRACTOR ON SITE PRIOR TO COMMENCEMENT OF WORKS.
 - AECOM LIMITED TO BE INFORMED BY THE CONTRACTOR OF ANY DISCREPANCIES PRIOR TO THE COMMENCEMENT OF WORKS ON SITE.
 - DIMENSIONS OF ALL BOUNDARIES AND ADJOINING ROADS TO BE CHECKED ON SITE PRIOR TO COMMENCEMENT OF WORKS.
 - DO NOT SCALE. ALL MEASUREMENTS AND COORDINATES TO BE CHECKED ON SITE.

LEGEND

- CARRIAGEWAY
- FOOTPATH
- ON ROAD CYCLE LANE
- OFF ROAD CYCLE TRACK
- SHARED SURFACE
- VERGE
- TACTILE PAVING
- LANDTAKE REQUIRED
- BELISHA BEACON
- EXISTING TREE TO REMAIN IN PLACE
- TREE TO BE REMOVED
- NEW TREE, STREETSCAPE
- NEW TREE, WOODLAND AREA
- PROPOSED ROOT TRENCH (Refer to Sheet 209 for details)
- TREE PROTECTION FENCE (To standard BS 5837:2012)

ISSUE/REVISION

NO.	DATE	DESCRIPTION
A	MAY 2018	ISSUE FOR PART 8
I/R	DATE	DESCRIPTION

KEY PLAN

DRAWN BY
BOD
PROJECT NUMBER
60520819
SHEET TITLE
ATHLUMNEY TO TRIM ROAD
CYCLE AND PEDESTRIAN SCHEME
LANDSCAPE WORKS PLAN

SHEET NUMBER
SHT_30_P8_CT_208