

PROPOSED PEDESTRIAN / CYCLE BRIDGE ATHLUMNEY STREET, NAVAN

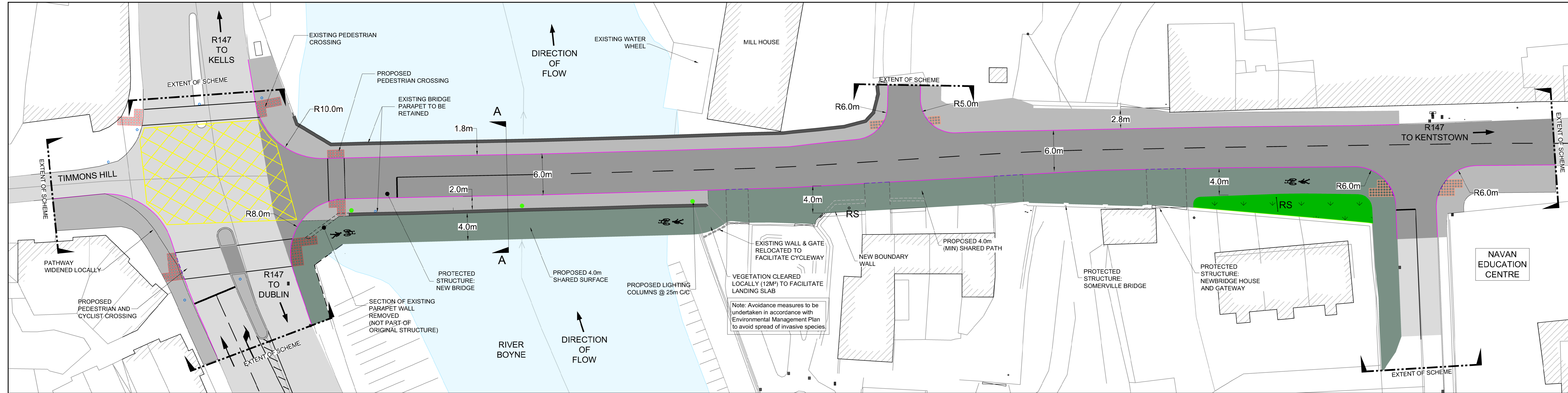
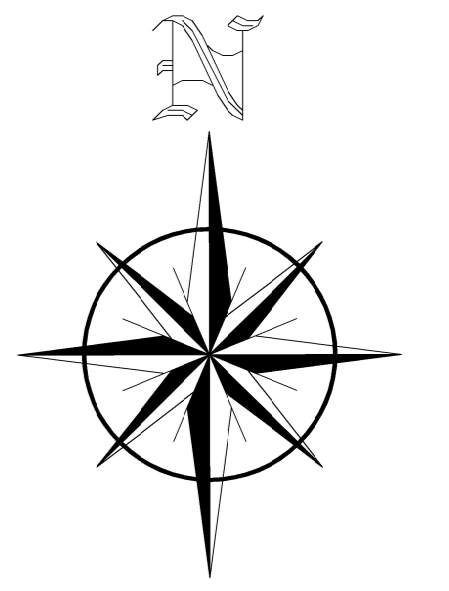

SITE PLAN
SCALE 1:250

LEGEND:

- DIRECTION OF FLOW →
- EXISTING CARRIAGEWAY
- PROPOSED NEW KERBLINE
- PROPOSED DROPPED KERB
- PROPOSED SHARED SURFACE
- PROPOSED GRASS AREA
- PROPOSED CARRIAGEWAY OVERLAY
- PROPOSED CONTROLLED / UNCONTROLLED TACTILE PAVING
- PROPOSED FOOTPATH
- EXISTING PARAPET
- PROPOSED LIGHTING COLUMNS

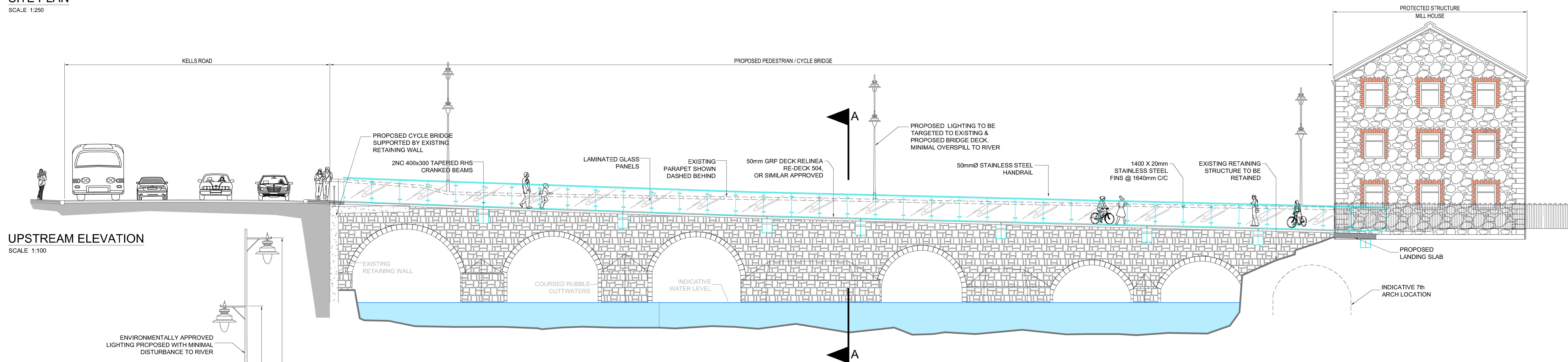

UPSTREAM ELEVATION
SCALE 1:100

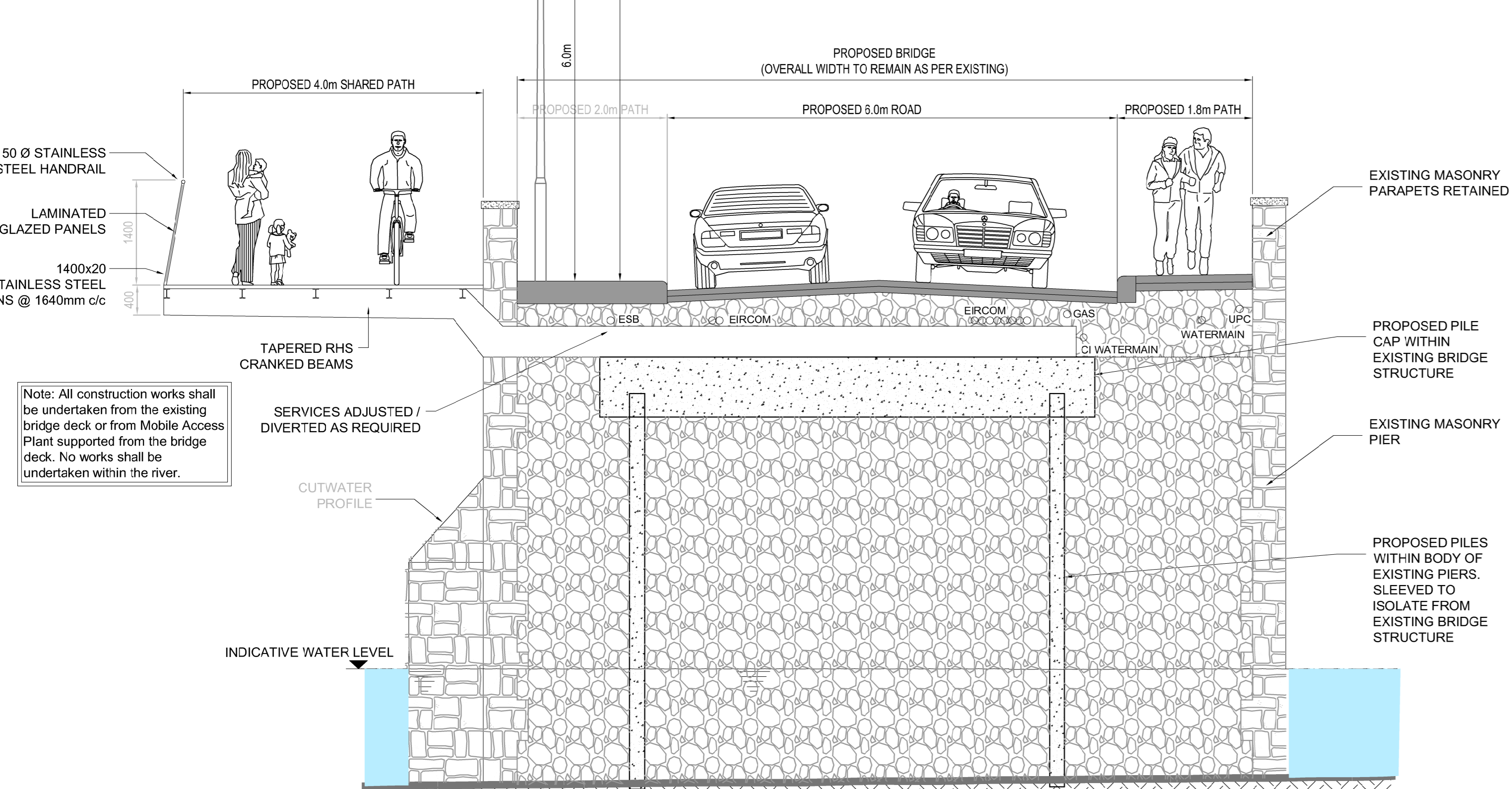

CROSS SECTION A-A - PROPOSED (Within Bridge Pier)
SCALE 1:50

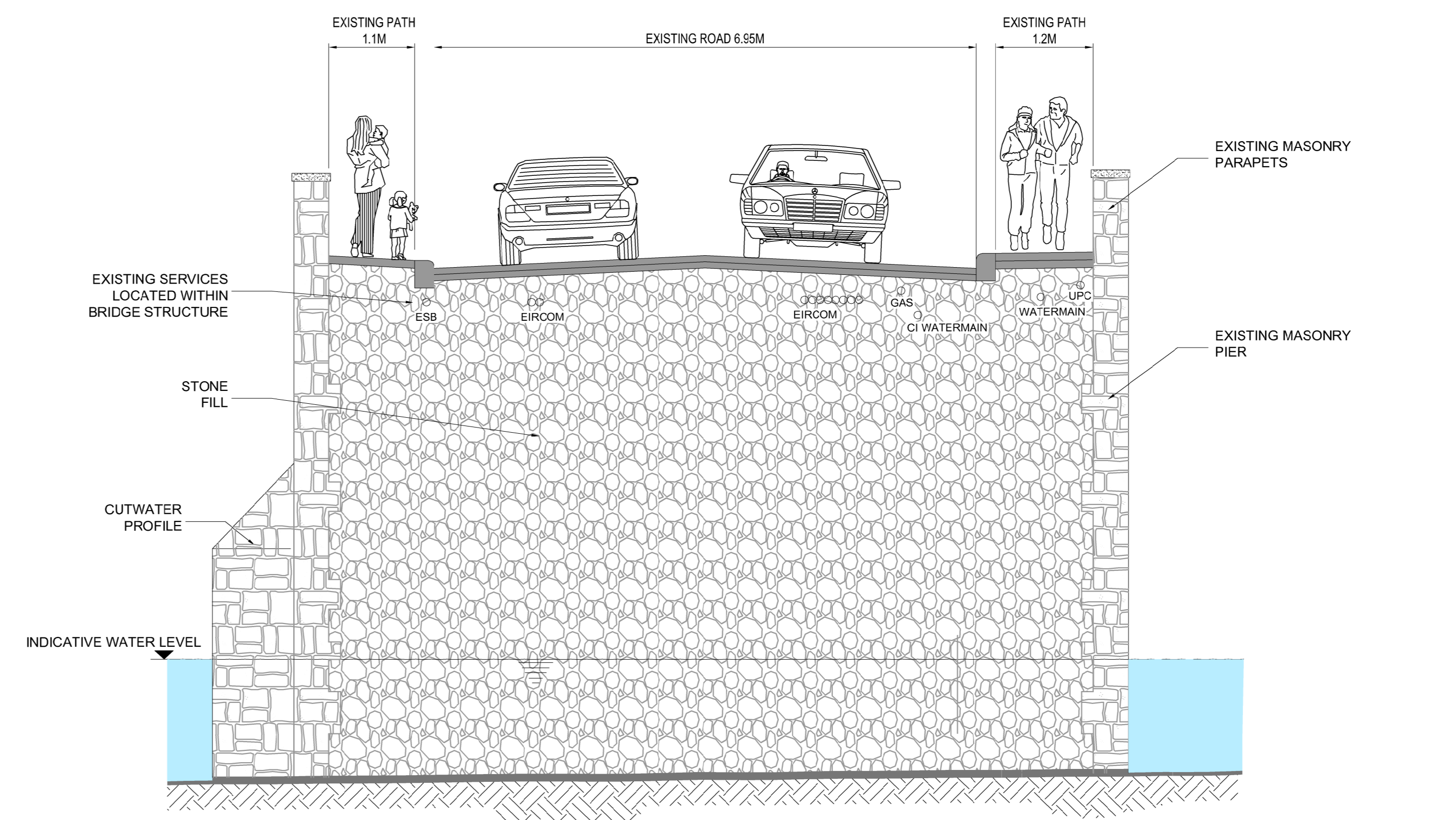

CROSS SECTION A-A - EXISTING
SCALE 1:50

Revision	Description	Initials	Date
PL07	Text Style Altered	MC	30/05/17
PL06	Environmental notes added	KF	12/04/17
PL05	General Adjustments	KF	13/03/17
PL04	Piles Added	KF	29/11/16
PL03	General Adjustments	KF	03/11/16
PL02	General Adjustments	MC	27/05/16

Clifton Scannell Emerson Associates
 Consulting Engineers,
 Seafort Lodge,
 Castlewoodon Avenue,
 Blackrock, Co. Dublin,
 Ireland.
 T: +353 1 288 5005
 F: +353 1 283 3466
 E: info@csea.ie
 W: www.csea.ie

Comhairle Bhaile na hUaimhe
NAVAN TOWN COUNCIL
 Client
PEDESTRIAN / CYCLE BRIDGE, NEW BRIDGE
 Project
NAVAN, CO. MEATH
 Part 8
PUBLIC DISPLAY DRAWING
 Drawn By: **KF** Date: **March 2016**
 Checked by: **MC** Scale: **AS SHOWN @ A0**
 Drawn Progress: **PART 8**
 Dwg. No.: **11_079A_00_4002-PL07**