

revision details

A	07/02/22	ISSUED FOR PLANNING
B	11/09/23	ISSUED FOR PART 8 APPLICATION

OSI LICENCE NO EN 0014523
 ALL LEVELS ARE IN METERS AND REFER TO ORDNANCE SURVEY DATUM (MALIN HEAD).
 CO-ORDINATES ARE TO ITM.

LEGEND

- SITE OUTLINE IN RED
- PROPOSED TYPICAL PRECAST HALF BATTER KERB (UPSTAND BETWEEN 100-150MM)
- ✳ 77.25 — PROPOSED FINISHED LEVEL
- 1/200 — PROPOSED ROAD GRADIENT
- + 4.25 — EXISTING LEVEL
- PROPOSED DROP RAMP WITH BUFF BLISTER TACTILE PAVING
- PROPOSED MIN. 1000MM HIGH Ø100MM BOLLARDS TO MEATH COCO SPECIFICATIONS (MIN.1.2M-MAX.1.8M SPACED APART, 0.3M AWAY FROM ROADWAY EDGE)
- EXISTING BOLLARDS TO BE RELOCATED

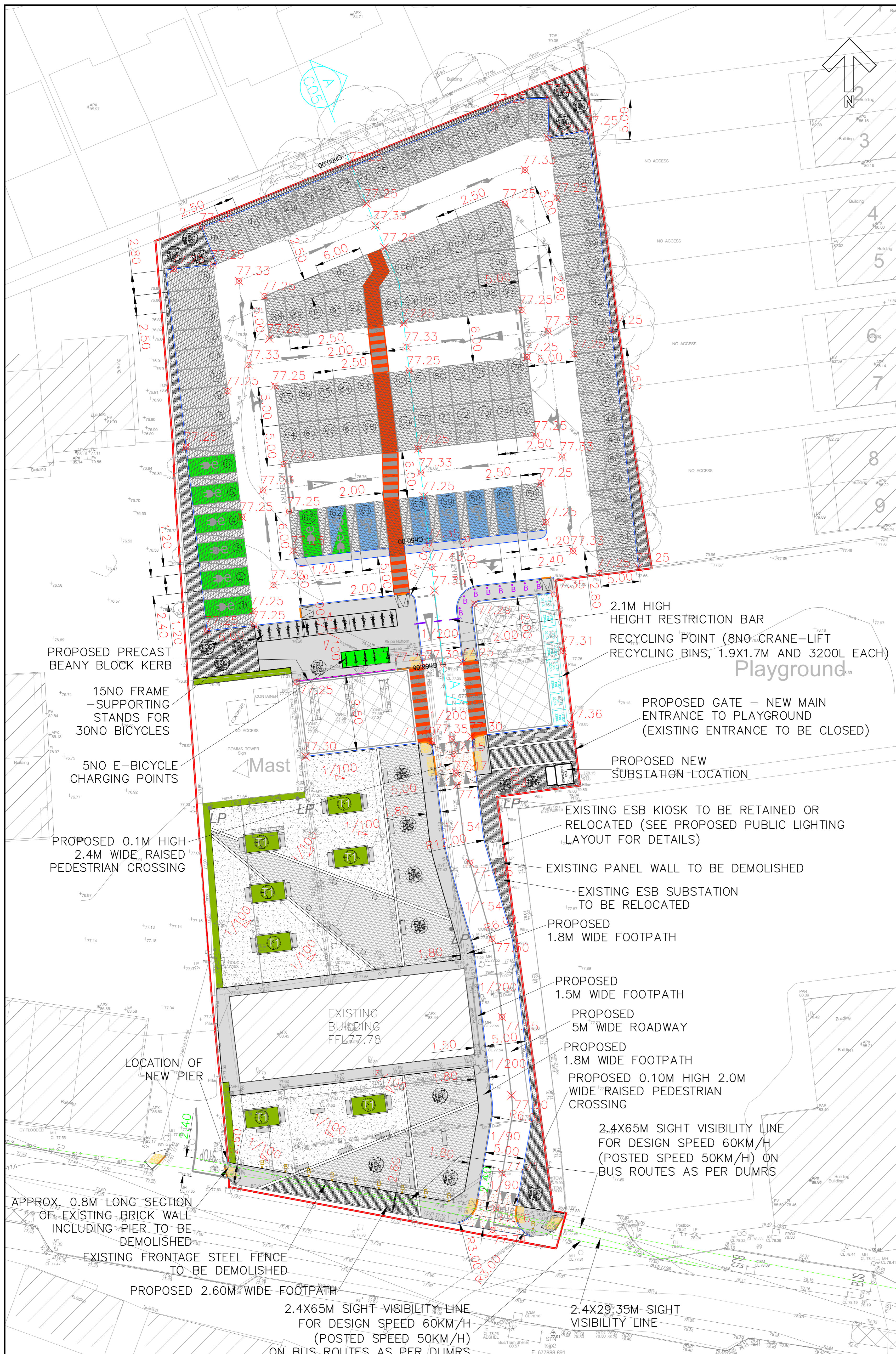

THIS DRAWING IS TO BE READ IN CONJUNCTION WITH ALL OTHER DCE DRAWINGS

DCE IRL
 CIVIL • STRUCTURAL • TRAFFIC

Second Floor, Avenue Road Centre
 Dundalk, Co. Louth, A91 FT92 Ireland
 Tel. : +353 42 935 1600
 Fax : +353 42 935 1601
 E-mail : info@dce.ie
 Web : www.dce.ie

Client: MEATH COUNTY COUNCIL

comhairle chontae na mí meath county council
 Job Title: ENFIELD - TOWN CENTRE PARKING

Drawing Title: PROPOSED SITE PLAN AND FINISHED LEVELS

Scale:	1:250@A1	Dwg no:	C02
Drawn by:	KK	Job no.:	4456
Checked by:	GJB	Rev. no.:	B
File no.:	4456 C02	Date:	07/02/22

SITE PLAN SCALE 1:250

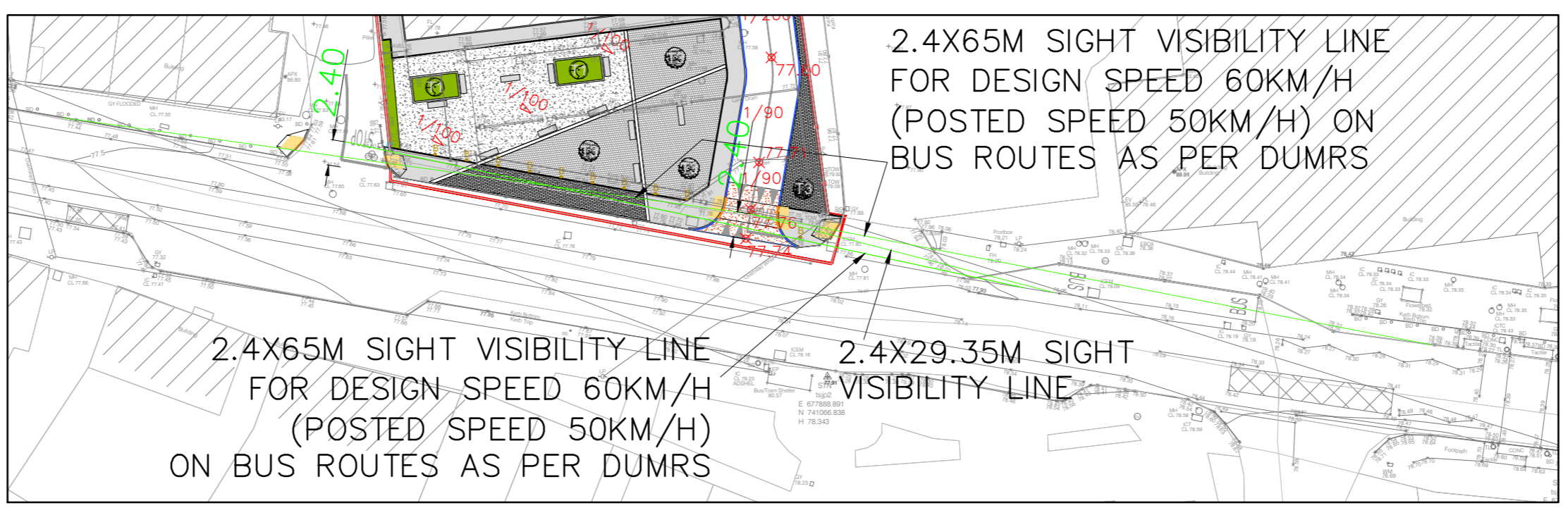

SIGHT VISIBILITY LINES SCALE 1:500

This document is the property of Duffy Chartered Engineers IRL. The design information contained herein is strictly confidential. This document is not to be used, reproduced, disclosed or circulated, in whole or in part, without the prior "Written Permission" in each instance of Duffy Chartered Engineers IRL.
 Duffy Chartered Engineers IRL. Registered Office: Jocelyn House, Jocelyn St., Dundalk, Co. Louth, Ireland. Registered in Ireland No. 574901. Directors: G.J. Barron, T. McGuinness. VAT No. IE 340160028