

DATE: 5 April 2022
DESIGNER: Alex Naper
PROJECT No: SES 04422 Rev A
PROJECT NAME: Enfield – Town Centre Parking



Access road designed in accordance with EN13201-2:2015
Category P3.

Carpark designed in accordance with EN12464-2:2014 5.9.2.

Bin area designed in accordance with EN13201-2:2015 Category C4

Junction section meets recommendations of EN13201-2:2015
Category C3.

Outdoor Lighting Report

PREPARED BY: Sabre Electrical Services Ltd.
Unit 11,
Bellview Industrial Estate,
Tolka Valley Road,
Dublin 11
Phone Number: 01 8110875
Contact: Graham Sheehan
eMail: graham@sabrelighting.ie

Layout Report

General Data

Dimensions in Metres Angles in Degrees

Calculation Grids

ID	Grid Name	X	Y	X' Length	Y' Length	X' Spacing	Y' Spacing
1	Grid 1	677853.66	741129.96	45.00	33.00	1.50	1.50
2	Grid 2	677830.99	741148.60	102.00	81.00	1.50	1.50
3	Grid 3	677850.18	741078.91	60.00	72.00	1.50	1.50
4	Grid 4	677846.34	741060.17	60.00	33.00	1.50	1.50

Luminaires



Luminaire A Data

Supplier	Urbis Schreder
Type	AXIA 2.2 5187 Integrated lenses 48 NVSL 219CT@890mA NW 740 2
Lamp(s)	48 NVSL219CT@890mA NW 740 230V
LampFlux(klm)/Colour	16.88 NW 4000K/70
File Name	AXIA 2.2 5187 48 NVSL219CT 890mA NW 740 134W 384882 Integrated lenses 230V...
Maintenance Factor	0.87
Imax70,80,90(cd/klm)	752.1, 124.8, 0.1
No. in Project	5

Luminaire B Data

Supplier	C U Phosco
Type	E950-28-P4A-730-C700-18W
Lamp(s)	730N
Lamp Flux (klm)	2.58
File Name	E950-28-P4A-730-C0700-18W.ies
Maintenance Factor	0.80
Imax70,80,90(cd/klm)	659.3, 183.1, 0.3
No. in Project	2

Luminaire C Data

Supplier	C U Phosco
Type	E950-28-P4A-730-C700-18W
Lamp(s)	730N
Lamp Flux (klm)	2.58
File Name	E950-28-P4A-730-C0700-18W.ies
Maintenance Factor	0.80
Imax70,80,90(cd/klm)	659.3, 183.1, 0.3
No. in Project	6

Luminaire D Data

Supplier	C U Phosco
Type	E950-28-A2A-730-C700-18W
Lamp(s)	730N
Lamp Flux (klm)	2.36
File Name	E950-28-A2A-730-C0700-18W.ies
Maintenance Factor	0.80
Imax70,80,90(cd/klm)	470.3, 22.7, 0.9
No. in Project	2

Luminaire E Data

Supplier	C U Phosco
Type	E950-28-F2A-730-SD0775-33W
Lamp(s)	730SA
Lamp Flux (klm)	4.68
File Name	E950-28-F2A-730-SD0775-33W.ies
Maintenance Factor	0.80
Imax70,80,90(cd/klm)	446.0, 41.1, 3.8
No. in Project	9

Layout

ID	Type	X	Y	Height	Angle	Tilt	Cant	Out-reach	Target X	Target Y	Target Z
1	A	677867.64	741066.91	9.00	78.00	0.00	0.00	1.50			
2	A	677816.15	741078.06	9.00	78.00	0.00	0.00	1.50			
3	A	677812.11	741094.80	9.00	255.00	0.00	0.00	1.50			
4	A	677837.38	741090.32	9.00	261.00	0.00	0.00	1.50			
5	A	677906.84	741079.43	9.00	263.00	0.00	0.00	1.50			
6	E	677859.20	741182.34	6.00	99.00	5.00	0.00	0.45			
7	E	677881.20	741185.04	6.00	95.00	5.00	0.00	0.45			
8	E	677859.23	741181.97	6.00	277.00	5.00	0.00	0.45			
9	E	677881.33	741184.56	6.00	277.00	5.00	0.00	0.45			
10	E	677853.58	741210.98	6.00	292.00	5.00	0.00	0.45			
11	E	677876.66	741220.10	6.00	295.00	5.00	0.00	0.45			
12	B	677895.66	741203.69	6.00	194.00	5.00	0.00	0.45			
13	B	677899.59	741173.95	6.00	183.00	5.00	0.00	0.45			
14	E	677842.03	741166.78	6.00	8.00	5.00	0.00	0.45			
15	E	677860.48	741153.32	6.00	92.00	5.00	0.00	0.45			
16	C	677879.40	741152.93	6.00	6.00	5.00	0.00	0.45			
17	C	677879.22	741153.00	6.00	187.00	5.00	0.00	0.45			
18	C	677879.71	741095.64	6.00	354.00	0.00	0.00	0.45			
19	C	677873.60	741127.97	6.00	10.00	0.00	0.00	0.45			
20	D	677857.92	741125.88	5.00	249.00	0.00	0.00	0.45			
21	D	677867.68	741091.31	5.00	291.00	0.00	0.00	0.45			
22	C	677873.52	741127.97	5.00	190.00	0.00	0.00	0.45			
23	E	677840.52	741188.37	6.00	6.00	5.00	0.00	0.45			
24	C	677890.06	741152.42	6.00	187.00	0.00	0.00	0.45			

Horizontal Illuminance (lux)

Grid 1

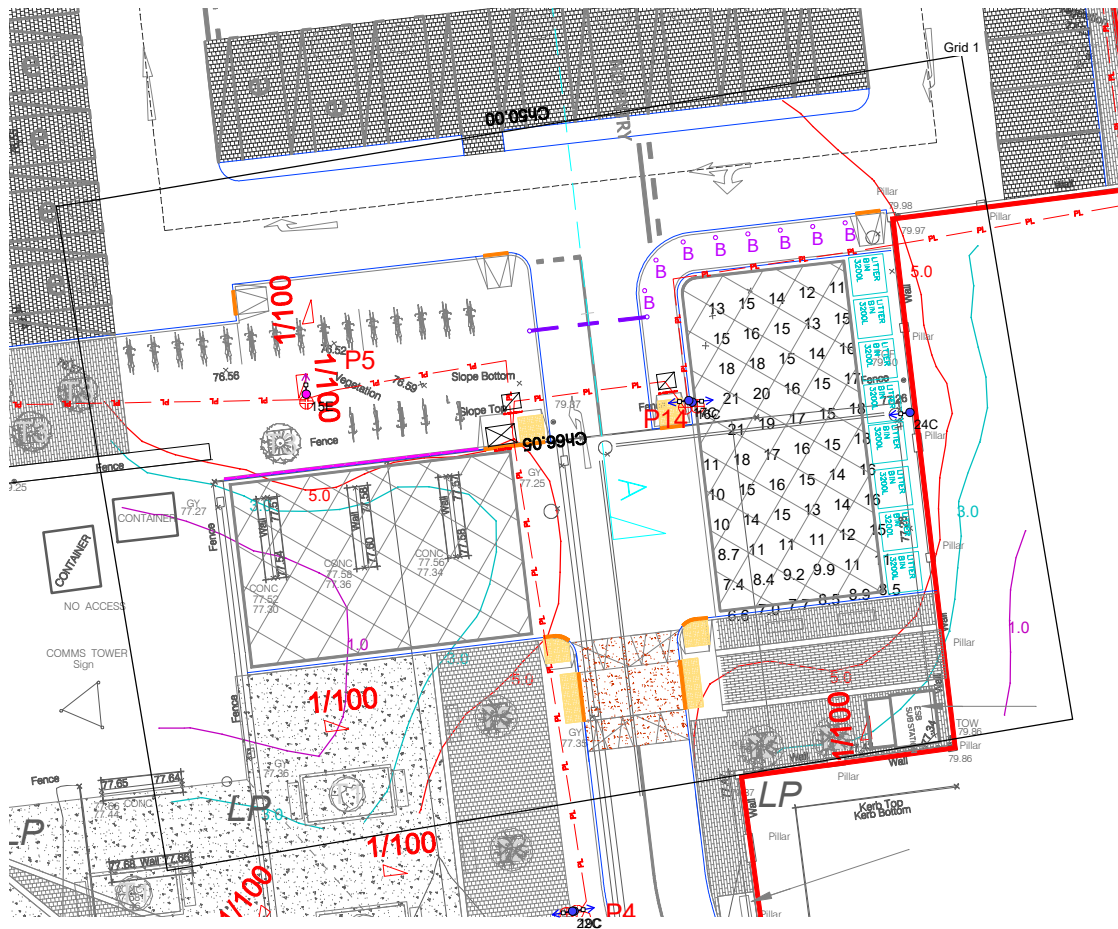

Results

Eav	13.71
Emin	6.57
Emax	21.36
Emin/Emax	0.31
Emin/Eav	0.48

Horizontal Illuminance (lux)

Grid 2

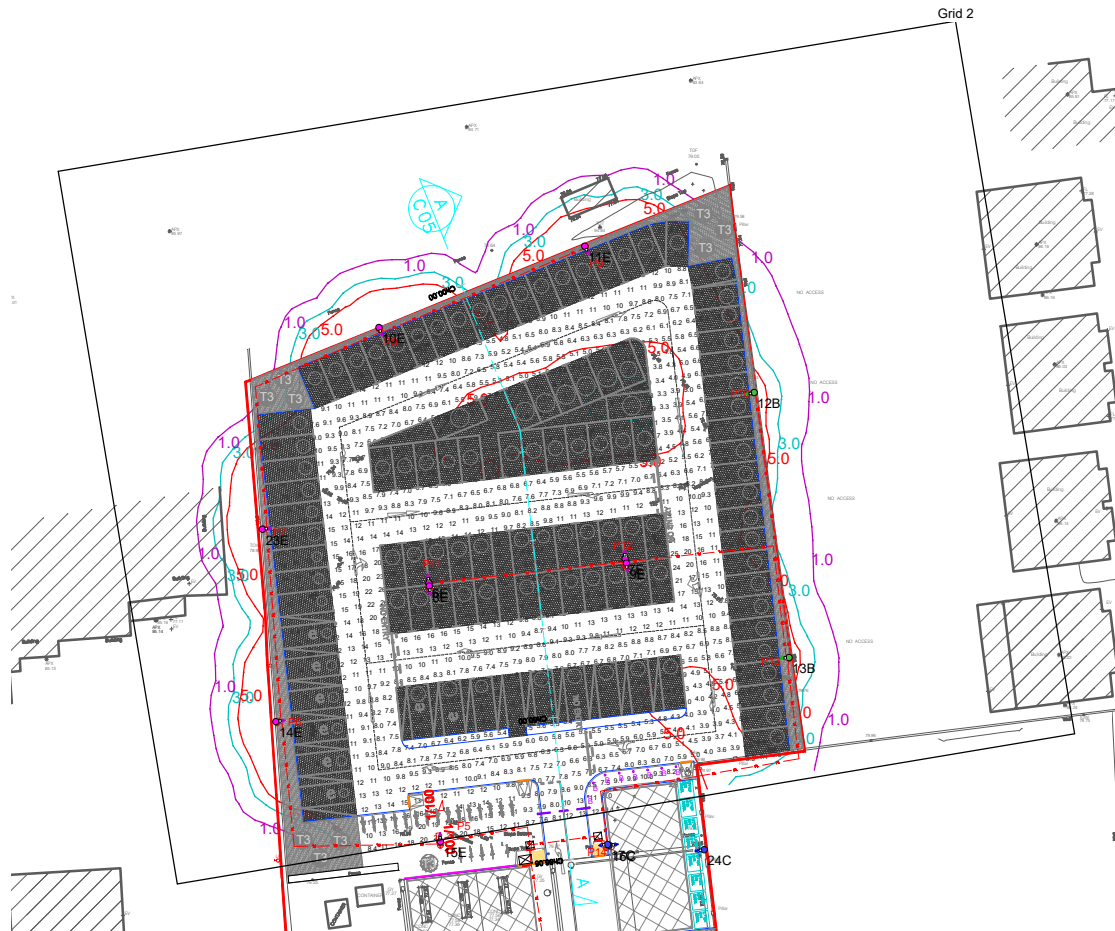

Results

Eav	10.19
Emin	2.64
Emax	35.97
Emin/Emax	0.07
Emin/Eav	0.26

Horizontal Illuminance (lux)

Grid 3



Results

Eav	7.64
Emin	1.60
Emax	28.32
Emin/Emax	0.06
Emin/Eav	0.21

Horizontal Illuminance (lux)

Grid 4

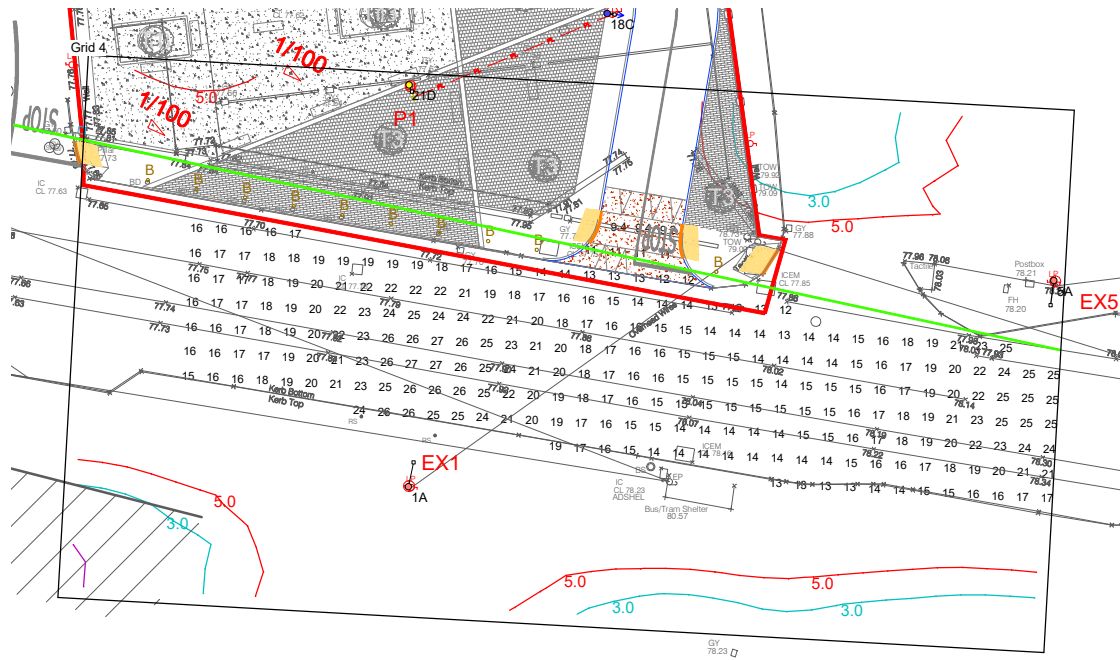

Results

Eav	18.00
Emin	9.19
Emax	26.82
Emin/Emax	0.34
Emin/Eav	0.51